

MXLTS1-105/1-110/1-115 TRIMLESS DOWNLIGHT, MINIATURE LINEAR LED

- Competitively priced trimless modular design
- 2700K, 3000K, 3500K, and 4000K CCT
- 1000-3000 delivered lumens (11W-33W)
- Dimming down to 1%*
- Insulation Contact (IC) rated
- (-WL) Wet Location option
- Wood Mounting Options available.

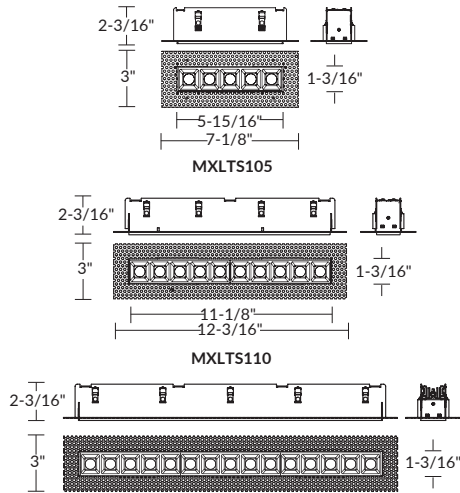

Matrix recessed linear wall washes and downlights are an aesthetic and performance upgrade from traditional linear fluorescent lighting with their high efficiency, and visual comfort. Matrix is available in flanged, trimless, and adjustable configurations from 1 to 15 cells to bring elegance and flexibility in a variety of lighting applications.



MXLTS105/MXLTS110/MXLTS115 (Flanged Frame)

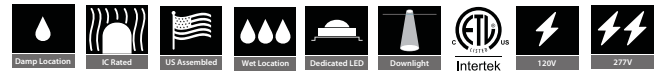

Ordering Example: MXLTS1-115ICBUE-D10-B30-T27-W

MXLTS1-115

Driver/Frame	Cell Finish	Dimming	Beam Spread	CCT	Mounting	Options
Driver/Frame		IC Option	Beam Spread		Mounting	
5-Cell, 1000lm (11W)	MXLTS1-105	Non-IC	15° Narrow Spot	-B15	Sheet Rock/Drywall	-Blank
10-Cell, 2000lm (22W)	MXLTS1-110	Insulation Contact (IC) Rated	30° Narrow Flood	-B30	Trimless Wood ¹	-WD
15-Cell, 3000lm (33W)	MXLTS1-115		40° Flood	-B40		
Cell Finish		Dimming	CCT		Options	
Black	B	0-10V Dimming (120V/277V)	2700K, 90 CRI	-T27	None	-Blank
White	W		3000K, 90 CRI	-T30	Emergency Backup	-EMAC
Silver	S	2-Wire INC/3-Wire ELV (120V)	3500K, 90 CRI	-T35	Wet Location	-WL
Custom	CSTM		4000K, 90 CRI	-T40		

ACCESSORIES

MXL105-FRM

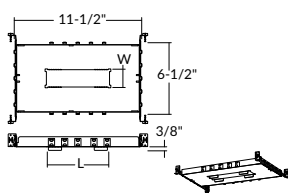

MATRIX Trim Ceiling Cut-Out:
MXLFG105: L 5-11-16" x W 1-5/8"
MXLTS105: L 5-15-16" x W 1-11-16"

MXL110-FRM

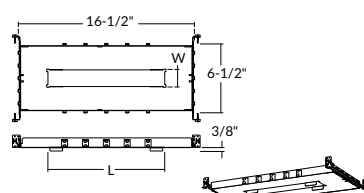

MATRIX Trim Ceiling Cut-Out:
MXLFG110: L 10-7/8" x W 1-5/8"
MXLTS110: L 11-1/8" x W 1-11-16"

MXL115-FRM

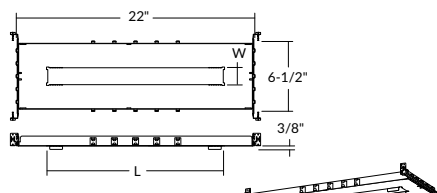

MATRIX Trim Ceiling Cut-Out:
MXLFG115: L 16-1/8" x W 1-5/8"
MXLTS115: L 16-3/8" x W 1-11-16"

¹ For Wood Ceiling Mounting, 1/2" Min. Thickness Needed. If using New Construction Housing.

² For (IC) rated, (MXLTS1-110) is 20W maximum, and (MXLTS1-115) is 28W maximum.

*Tested with Lutron Skylark SELV-300P & Maestro MAELV-600 Dimmers.

SPECIFICATION

Applications

Matrix recessed linear wall washes and downlights are available in flanged, trimless, and adjustable configurations from 1 to 15 cells, to bring quiet elegance and contemporary sophistication to governmental, educational, commercial, hospitality and retail lighting applications.

Housing

Aluminum, designed to secure to existing sheetrock ceilings up to 1" thick with drywall screws. Mudding may be applied right up to the edge of the fixture to produce smooth uninterrupted planar surfaces. IC rated housing rated for direct contact with low to medium density loosefill blown and rolled insulation.

Reflectors

A series of 1.4" square cells hold single LED diodes that provide excellent visual cut off with a very comfortable Unified Glare Rating (UGR) of less than 10. Cell Finish is available in black, white or silver finish. Custom colors are available. Contact factory.

LED Details

Color Temperature - Osram LEDs are binned to 3-step MacAdam ellipses within the ANSI C78 377A standard for color temperature and chromaticity ranges light binning allowance. 90 CRI standard.

Lumen Maintenance - Minimum 50,000 hours L70 life based on ANSI TM-21 calculations from LM80 standardized test results.

Dimming Details

Driver - Externally mounted. Highly efficient 24V DC with a power factor up to 0.99. 120V/277V AC for any residential or commercial applications.

Dimming - Superior PWM dimming technology compatible with many models of Triac, ELV, MLV, forward and reverse phase dimmers, and on/off switches.

(UE-D10) 0-10V dimming option dims down to 1% and works with most 120V/277V 5-wire, 0-10V dimmers.

(-DIN) dimming option smoothly dims down to 1% of initial light output with flicker-free performance when tested with Lutron Skylark SELV-300P and Maestro MAELV-600 dimmers. Works with standard 120V incandescent dimmers.

Thermal Management - Effective thermal management facilitated by integral extruded aluminum heat sink design for maximum heat dissipation to provide long LED life.

Emergency Option

Emergency LED Battery Back-up available, remotely mounted adjacent to housing by installer. When AC power fails, the device immediately switches to the emergency mode, operating the LEDs for a minimum of 90 minutes. Remote test switch and plate cover included. (-EMAC) is not wet location rated, and must be mounted in a dry area.

Certifications and Listings

ETL/cETL listed to UL1598 and UL8750. Suitable for dry and damp locations. NYC approved: Calendar #41937. Insulation Contact (IC) rated housing rated for direct contact with loosefill blown and rolled insulation. Optional (-WL) Wet Location option is suitable for wet locations, covered ceiling only.

Warranty

Covered by a 5-Year Warranty to be free of defects in materials and craftsmanship. Recommended for applications where ambient temperatures do not exceed 35°C. Installations exceeding this temperature will result in reduced LED lamp life and a voided warranty.

Accessories

MXL1XX-FRM - New Construction Frame (Round). Suitable for new construction and remodel installations. Adjusts up to 1" ceiling thickness. Supplied with (2) 24" adjustable hanger bars with nail-less install 3/4" serrated barbed studs for mounting in wood joists.

MXL105-FRM: 11-1/2" x 6-1/2" x 3/8"

MXL110-FRM: 16-1/2" x 6-1/2" x 3/8"

MXL115-FRM: 22" x 6-1/2" x 3/8"